

GENERAL NOTES

1. USE THESE DOCUMENTS IN CONJUNCTION WITH THE STANDARD DESIGN GUIDE AND INTERACTIVE PROGRAMMING WORKSHEET

DRAWING LIST	
NUMBER	NAME
C-1	COVER SHEET
A-1	STANDARD DESIGN PLAN
A-2	MODULES A & B PLANS & AXONS
A-3	MODULE C PLAN & AXON
A-4	MODULE D PLAN & AXON
A-5	MODULES E, F & G PLANS & AXONS

AIR FORCE STANDARD DESIGN CES SHOPS/WAREHOUSE BUILDING



PHASE: PRE-FINAL SUBMITTAL
DATE: MARCH 2018
SCALE: AS INDICATED

**AIR FORCE
CIVIL ENGINEER
CENTER**







CIVIL ENGINEER SQUADRON:
SHOPS/ WAREHOUSE BUILDING
ANY AFB, CONUS
COVER SHEET

SHEET
NUMBER
C-1

MARCH 2018

NOT FOR CONSTRUCTION

MODULE TYPE LEGEND

 A-FACILITY SYSTEMS ELEMENT	 C- HEAVY REPAIR ELELMENT SHOP	 E-FACILITY BREAK ROOM	 G-BUILDING SUPPORT
 B-INFRASTRUCTURE ELEMENT	 D - MATERIAL CONTROL/ WAREHOUSING	 F-TOILET	

BUILDING NOTES

THIS BASIS OF DESIGN CONCEPT FLOOR PLAN IS BASED ON THE APPROVED FUNCTIONAL ADJACENCY DIAGRAM. THE ROOM CRITERIA IS LOCATED I NTHE ROOM DATA SHEETS IN THE STANDARD DESIGN DOCUMENT AND THE ROOM SIZES ARE LOCATED IN THE INTERACTIVE PROGRAMMING WORKSHEET. THE OVERALL DIMENSIONS ARE APPROXIMATE AS THE BASIS OF DESIGN CONCEPT PLAN DOES NOT INDICATE STRUCTURAL ELEMENTS, ALL PLUMBING CHASES, MISCELLANEOUS UTILITY ROOMS (MECHANICAL, ELECTRICAL, COMMUNICATION) OR WALL THICKNESSES, ETC.



PHASE:	PRE-FINAL SUBMITTAL
DATE:	MARCH 2018
SCALE:	AS INDICATED

**AIR FORCE
CIVIL ENGINEER
CENTER**

CIVIL ENGINEER SQUADRON:
SHOPS/ WAREHOUSE BUILDING
ANY AFB, CONUS

**STANDARD DESIGN
PLAN**

SHEET
NUMBER
A-1

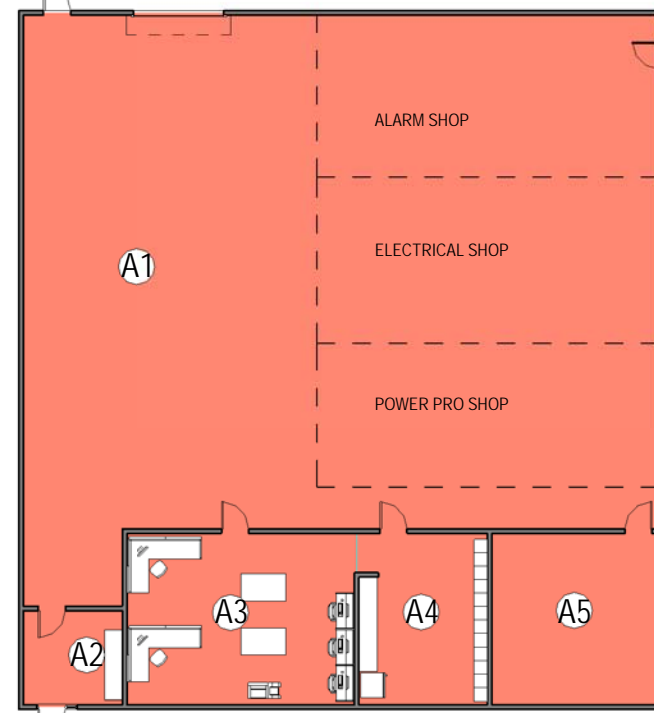

- (A1) FACILITY SYSTEMS SHOP
- (A2) CUSTOMER SERVICE LOBBY
- (A3) ADMINISTRATION OFFICE
- (A4) BREAK/LOCKER AREA
- (A5) TOOL STORAGE

TOTAL AREA OF MODULE = 5,210 NET SF

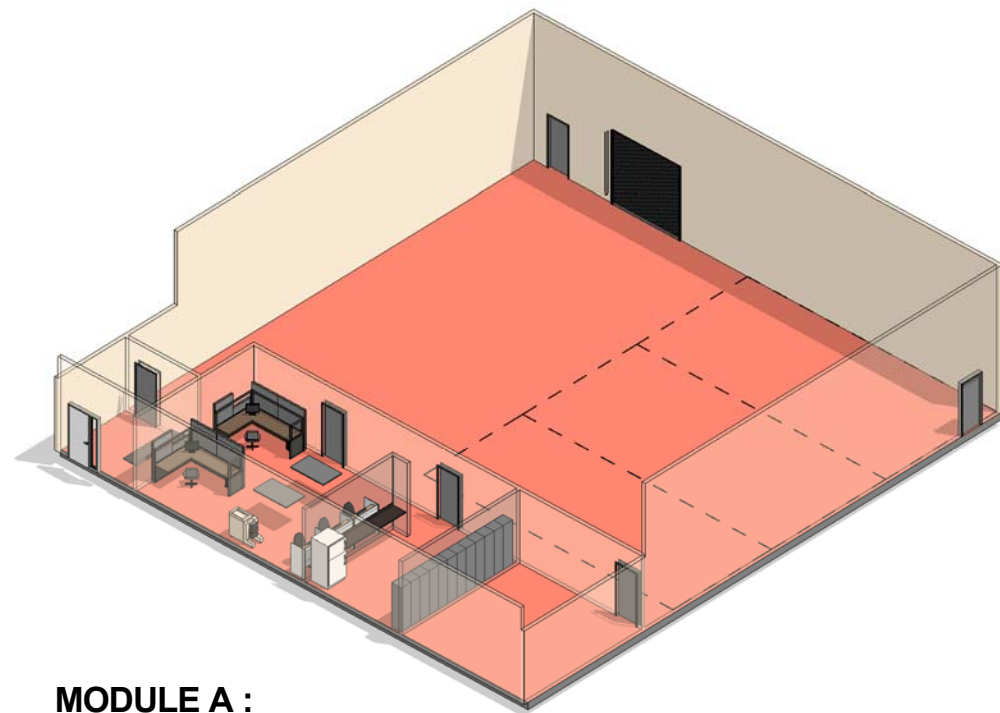

**MODULE A :
FACILITY SYSTEMS ELEMENT**

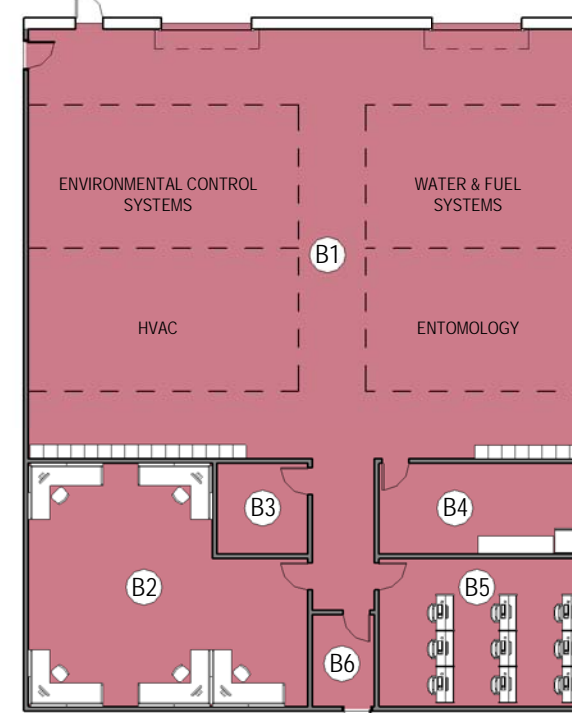

- (B1) INFRASTRUCTURE SHOPS
- (B2) INFRASTRUCTURE ADMINISTRATION OFFICE
- (B3) COPY/FILE STORAGE
- (B4) INFRASTRUCTURE BREAK ROOM
- (B5) INFRASTRUCTURE HOTELING
- (B6) ENTRANCE LOBBY

TOTAL AREA OF MODULE = 4,535 SF

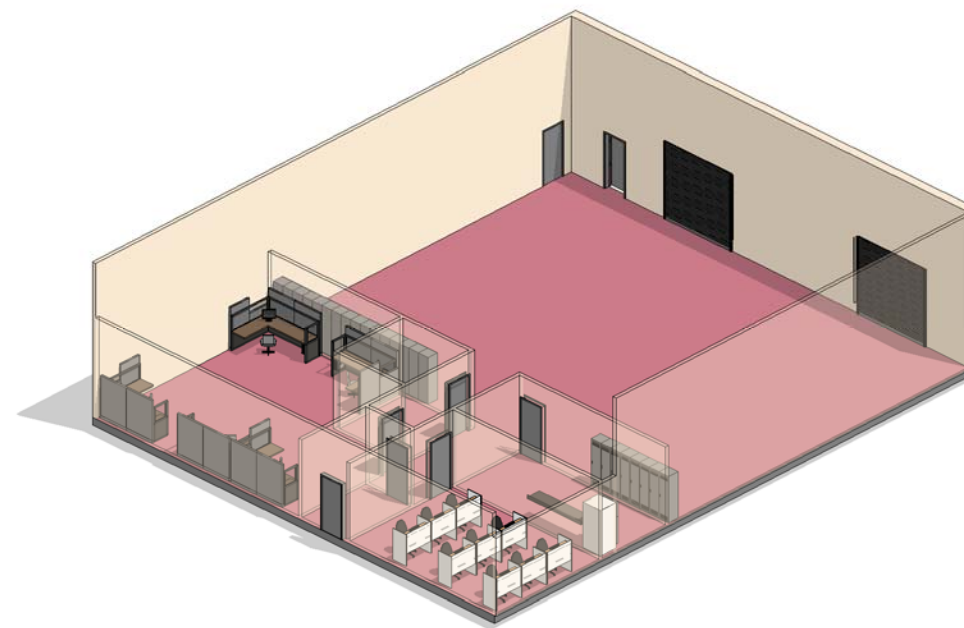

**MODULE B :
INFRASTRUCTURE ELEMENT**

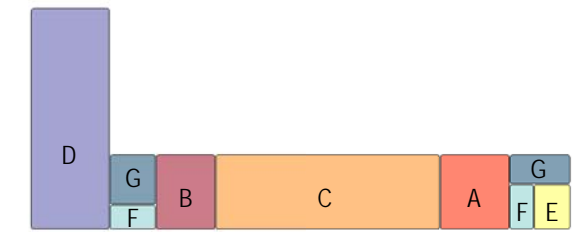

KEYPLAN

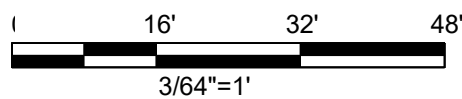

PHASE:	PRE-FINAL SUBMITTAL
DATE:	MARCH 2018
SCALE:	AS INDICATED

**AIR FORCE
CIVIL ENGINEER
CENTER**

CIVIL ENGINEER SQUADRON:
SHOPS/ WAREHOUSE BUILDING
ANY AFB, CONUS
**MODULES A & B
PLANS & AXONS**

SHEET
NUMBER
A-2

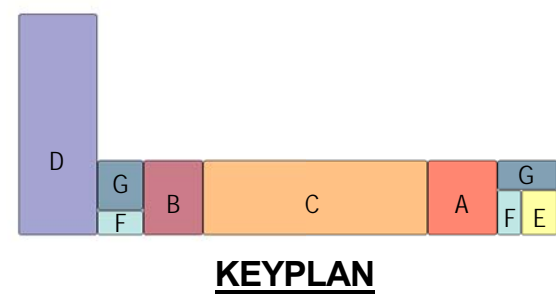
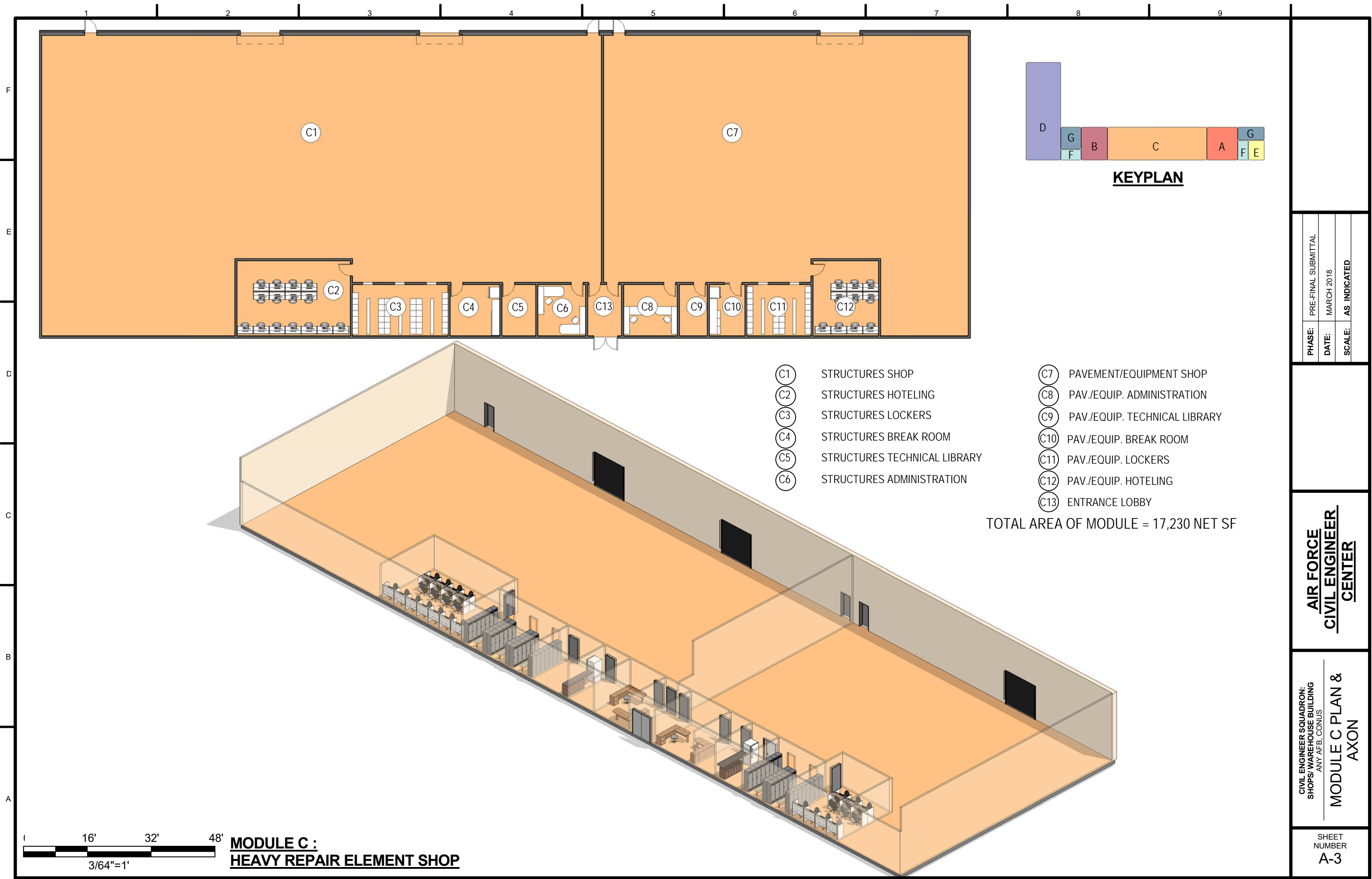

- (C1) STRUCTURES SHOP
- (C2) STRUCTURES HOTELING
- (C3) STRUCTURES LOCKERS
- (C4) STRUCTURES BREAK ROOM
- (C5) STRUCTURES TECHNICAL LIBRARY
- (C6) STRUCTURES ADMINISTRATION
- (C7) PAVEMENT/EQUIPMENT SHOP
- (C8) PAV./EQUIP. ADMINISTRATION
- (C9) PAV./EQUIP. TECHNICAL LIBRARY
- (C10) PAV./EQUIP. BREAK ROOM
- (C11) PAV./EQUIP. LOCKERS
- (C12) PAV./EQUIP. HOTELING
- (C13) ENTRANCE LOBBY

TOTAL AREA OF MODULE = 17,230 NET SF

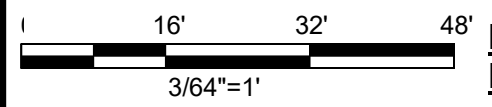

**MODULE C :
HEAVY REPAIR ELEMENT SHOP**

PHASE:	PRE-FINAL SUBMITTAL
DATE:	MARCH 2018
SCALE:	AS INDICATED

**AIR FORCE
CIVIL ENGINEER
CENTER**

CIVIL ENGINEER SQUADRON:
SHOPS/WAREHOUSE BUILDING
ANY AFB, CONUS
**MODULE C PLAN &
AXON**

SHEET
NUMBER
A-3

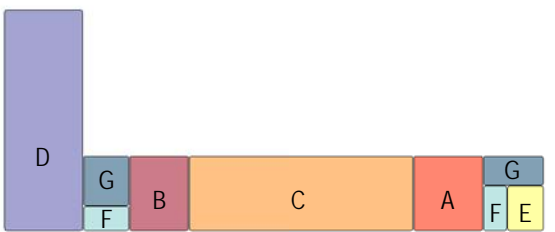
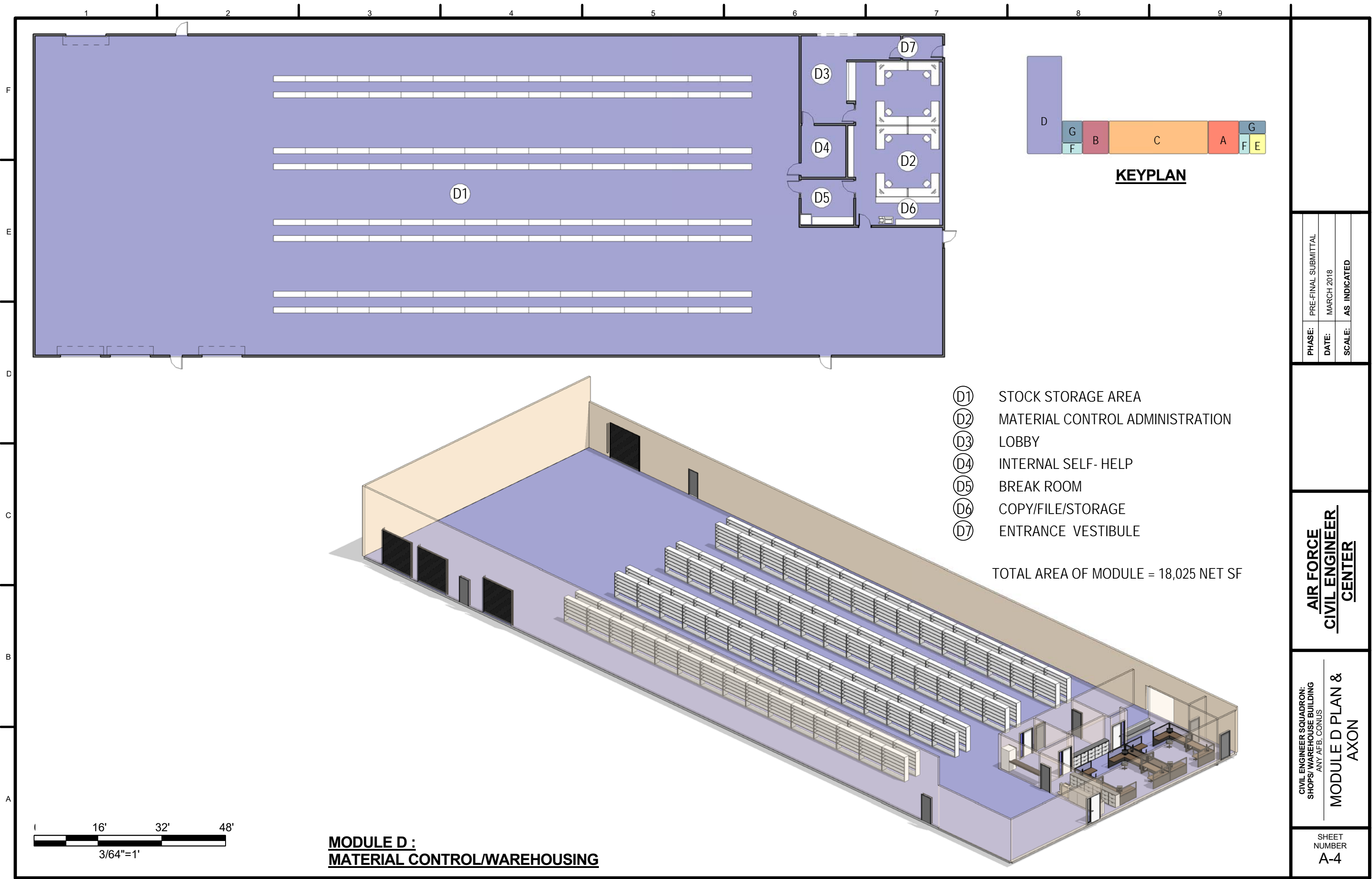

KEYPLAN

- ⓓ1 STOCK STORAGE AREA
- ⓓ2 MATERIAL CONTROL ADMINISTRATION
- ⓓ3 LOBBY
- ⓓ4 INTERNAL SELF- HELP
- ⓓ5 BREAK ROOM
- ⓓ6 COPY/FILE/STORAGE
- ⓓ7 ENTRANCE VESTIBULE

TOTAL AREA OF MODULE = 18,025 NET SF

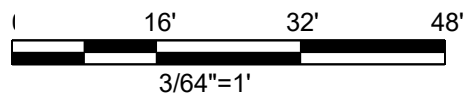

**MODULE D :
MATERIAL CONTROL/WAREHOUSING**

PHASE:	PRE-FINAL SUBMITTAL
DATE:	MARCH 2018
SCALE:	AS INDICATED

**AIR FORCE
CIVIL ENGINEER
CENTER**

CIVIL ENGINEER SQUADRON:
SHOPS/ WAREHOUSE BUILDING
ANY AFB, CONUS
**MODULE D PLAN &
AXON**

SHEET
NUMBER
A-4

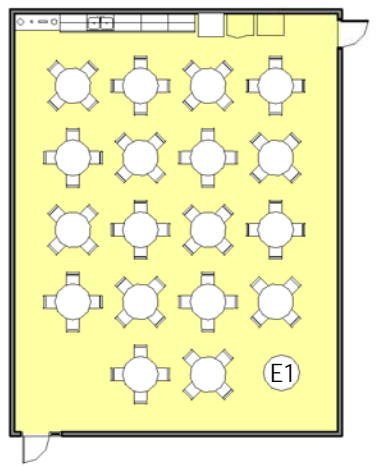
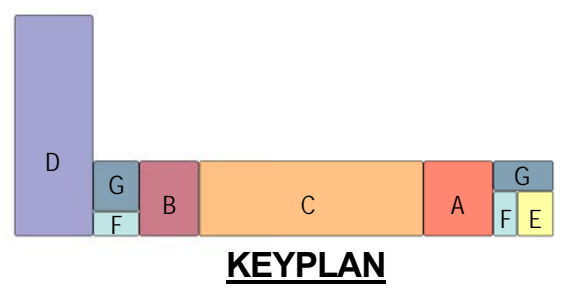
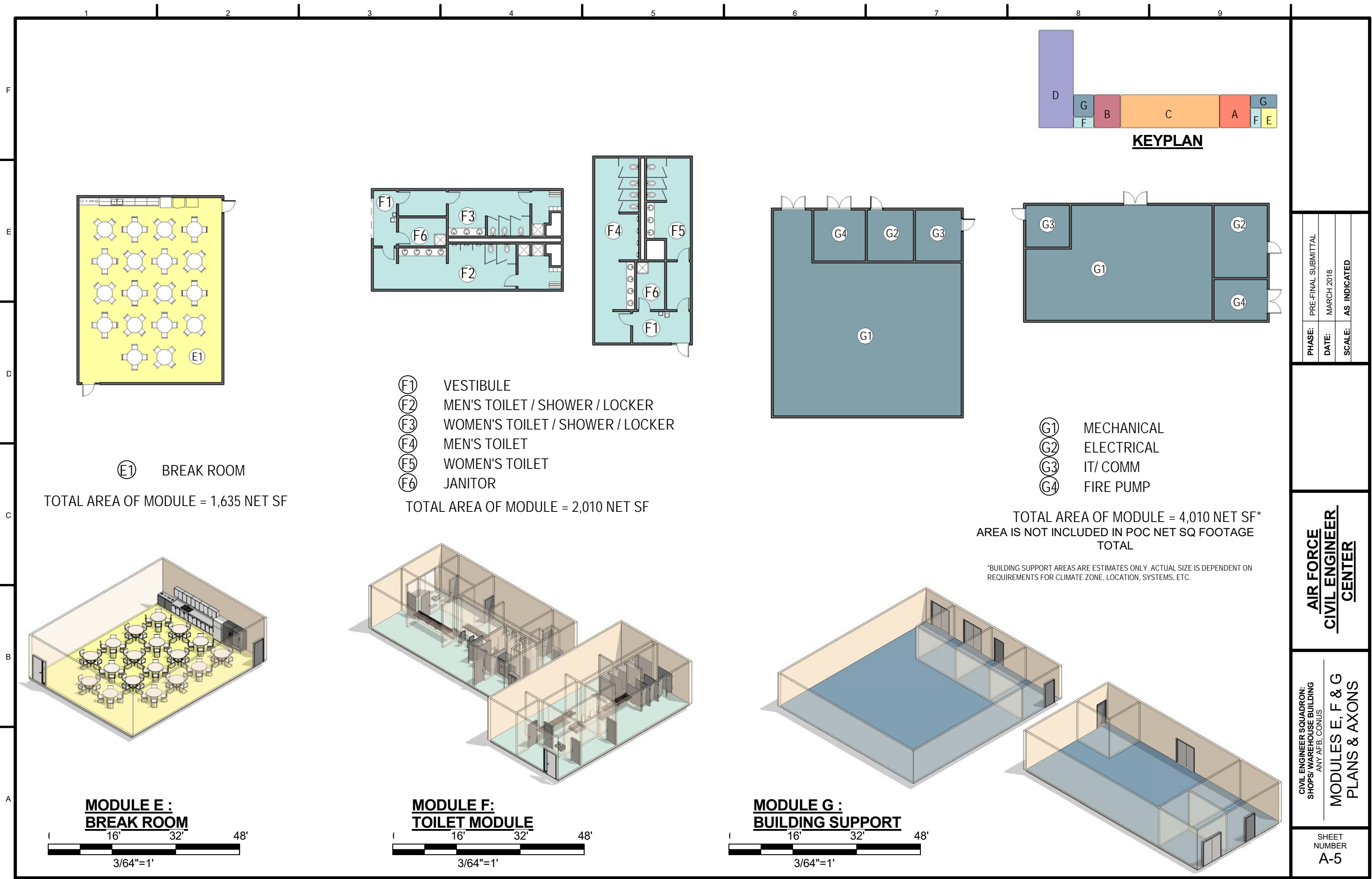

ⓔ BREAK ROOM

TOTAL AREA OF MODULE = 1,635 NET SF

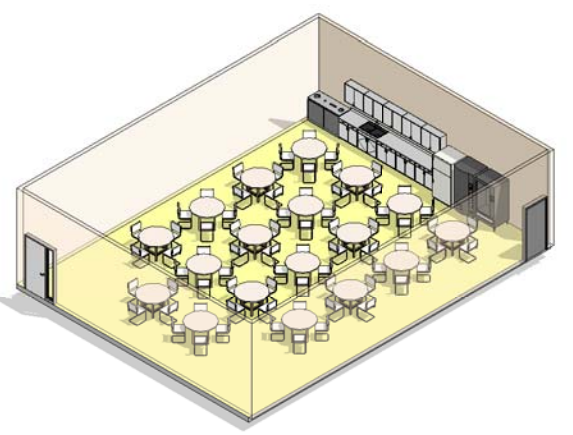

**MODULE E :
BREAK ROOM**

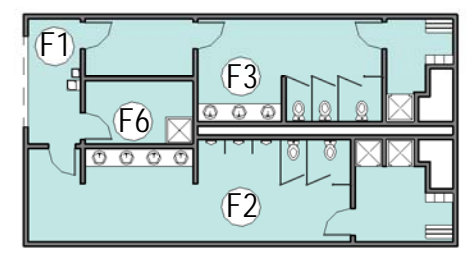
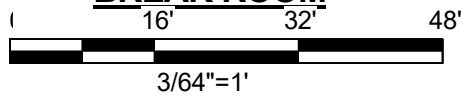

- ⓕ1 VESTIBULE
- ⓕ2 MEN'S TOILET / SHOWER / LOCKER
- ⓕ3 WOMEN'S TOILET / SHOWER / LOCKER
- ⓕ4 MEN'S TOILET
- ⓕ5 WOMEN'S TOILET
- ⓕ6 JANITOR

TOTAL AREA OF MODULE = 2,010 NET SF

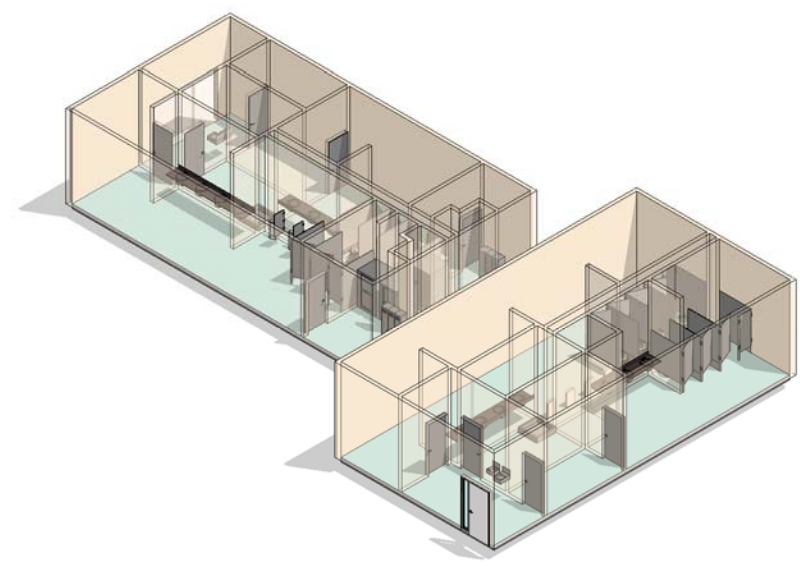

**MODULE F :
TOILET MODULE**

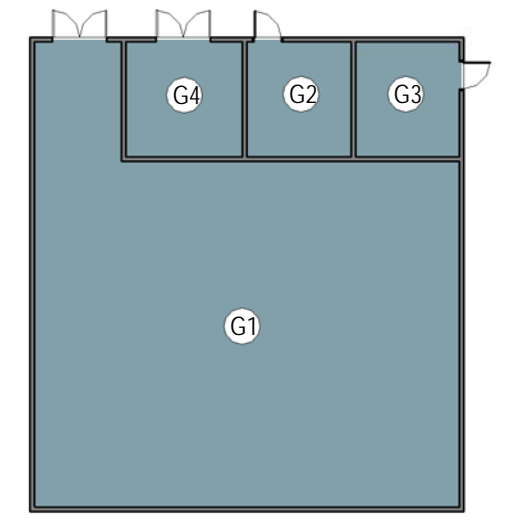
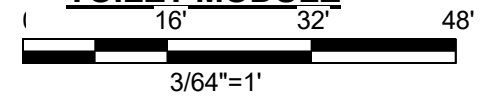

- ⓖ1 MECHANICAL
- ⓖ2 ELECTRICAL
- ⓖ3 IT/ COMM
- ⓖ4 FIRE PUMP

TOTAL AREA OF MODULE = 4,010 NET SF*
AREA IS NOT INCLUDED IN POC NET SQ FOOTAGE TOTAL

*BUILDING SUPPORT AREAS ARE ESTIMATES ONLY. ACTUAL SIZE IS DEPENDENT ON REQUIREMENTS FOR CLIMATE ZONE, LOCATION, SYSTEMS, ETC.

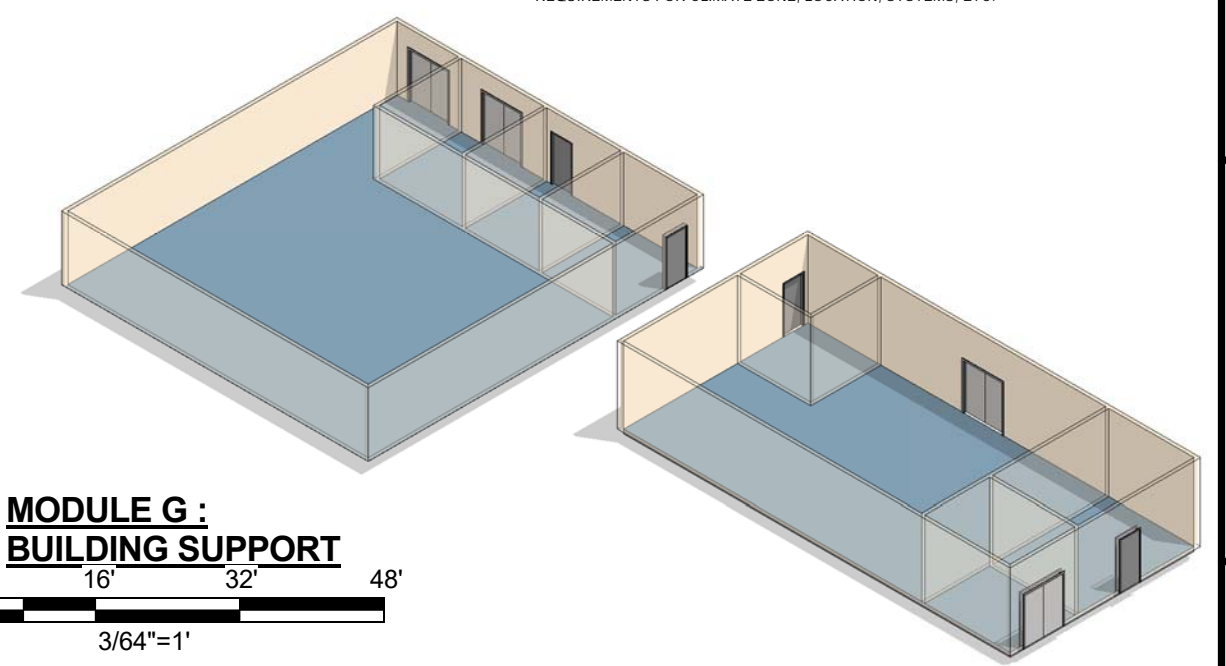

**MODULE G :
BUILDING SUPPORT**

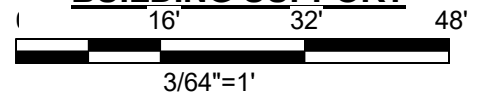

PHASE:	PRE-FINAL SUBMITTAL
DATE:	MARCH 2018
SCALE:	AS INDICATED

**AIR FORCE
CIVIL ENGINEER
CENTER**

CIVIL ENGINEER SQUADRON:
SHOPS/ WAREHOUSE BUILDING
ANY AFB, CONUS
**MODULES E, F & G
PLANS & AXONS**

SHEET NUMBER
A-5